



DIECI

DESIGN BY

pininfarina



"Italian style means sense of proportion, simplicity, and harmony of line, such that after a considerable time there is still something which is more alive than just the memory of beauty"

- -Battista Pinin Farina



pininfarina

A global icon of Italian style with offices in Italy, the United States, China and Germany, Pininfarina is recognized for its unparalleled ability to create timeless beauty through its values of elegance, purity and innovation.

Founded in 1930, Pininfarina has evolved from a artisan company to an international services group, the ultimate expression of automotive styling and an established reality in industrial and experiential design, architecture, nautical and mobility beyond the automotive industry. Over the course of nine decades, Pininfarina has designed more than 1,300 automotive and mobility projects and more than 650 product and architecture projects, receiving more than 70 international design awards in the last 10 years.

From 2021, for the third consecutive year, the design studio Pininfarina of America has been certified among the top Great Place to Work in the United States, where it has offices in Miami and New York City.



PININFARINA
Residential Architecture

- Panamá City, Panamá
- Miami, USA
- Sao Paulo, Brazil
- João Pessoa, Brazil
- Fortaleza, Brazil
- Maringá, Brazil
- Belo Horizonte, Brazil
- Porto Alegre, Brazil
- Balneario Camboriú, Brazil
- Mexico City, Mexico
- Tulum, Mexico
- Mérida, Mexico
- Guatemala City, Guatemala
- Buenos Aires, Argentina
- Shunde, China
- Dubái, United Arab Emirates



PANAMA
A journey through the eyes of Pininfarina

Panama is an inspiring country, where diversity and connectivity have become its foundation.

Panama has a unique and recognizable identity, marked by its rich cultural heritage and strategic geographical location.

Panama, a nation of ten vibrant provinces.



The illustrations and images are conceptual and may vary from concept to actual construction.

Two towers united by the natural and relaxed atmosphere of the Costa del Este, in a country surrounded by two oceans: the Atlantic and the Pacific.

DIECI DESIGN BY PININFARINA embraces the geographical and cultural heritage of Panama with an elevated design proposal, a manifesto of natural richness in perfect harmony with contemporary and functional architecture.



About Panama

In the heart of Central America, where a lush tropical paradise meets crystal clear waters, lies the Isthmus of Panama, a geographical marvel that connected four continents in the 16th century.

A country defined by water in every sense: geographically, historically, economically, architecturally and culturally, it is a testament to the symbiotic relationship between man and nature. Its green landscapes and diverse fauna throughout its geography reflect this harmony.

Panama, the hub of the Americas, strategically located between the Atlantic and Pacific Oceans, is the most connected country in the Americas, serving as a bridge for global trade.

At the center of this connectivity is the stunning Panama Canal, an engineering masterpiece that challenged nature to unite oceans and continents. The mastery and craftsmanship that distinguish Pininfarina's Italian design are evident in the architecture proposed for DIECI in Panama City.



COSTA DEL ESTE, PANAMA CITY
PANAMA





DIECI
DESIGN BY PININFARINA

The mastery and craftsmanship that distinguish Pininfarina's Italian design are evident in the architecture proposed for DIECI in Panama City.

Located in Costa del Este, Panama City, Panama. A place that embraces contemporaneity, where streets connect like threads, green spaces evoke biodiversity that contributes to the city's lungs, and its architecture blends innovation with tradition; all designed with the purpose of providing greater tranquility, accessibility and an exceptional quality of life.

DIECI is an iconic world-class residential masterpiece designed for a visionary and dynamic urban lifestyle.

DIECI is an investment in an architectural legacy designed by the global icon Pininfarina.



A world class residential building full of experiences

ULTRA-LUXURY BUILDING EXPERIENCES



ULTRA-LUXURY
BUILDING EXPERIENCES

GROUND FLOOR

The lobby area is a place where the charm and colors of the Panamanian rainforest can be found, inspiring all residents and guests. A design by Pininfarina dedicated to promoting an atmosphere of comfort and relaxation. The ground floor offers an earthy and tranquil welcome, while the mezzanine is dedicated to fitness, active wellness and beauty.

Lobby Area

- Valet Parking
- Lobby Services
- Concierge Service
- Coffee & Juice Library
- Business Center
- Bike station
- Retail Spaces

Mezzanine

- Fitness Center
- Boxing Club
- Pilates Room
- Spinning Room
- Spa and Wellness

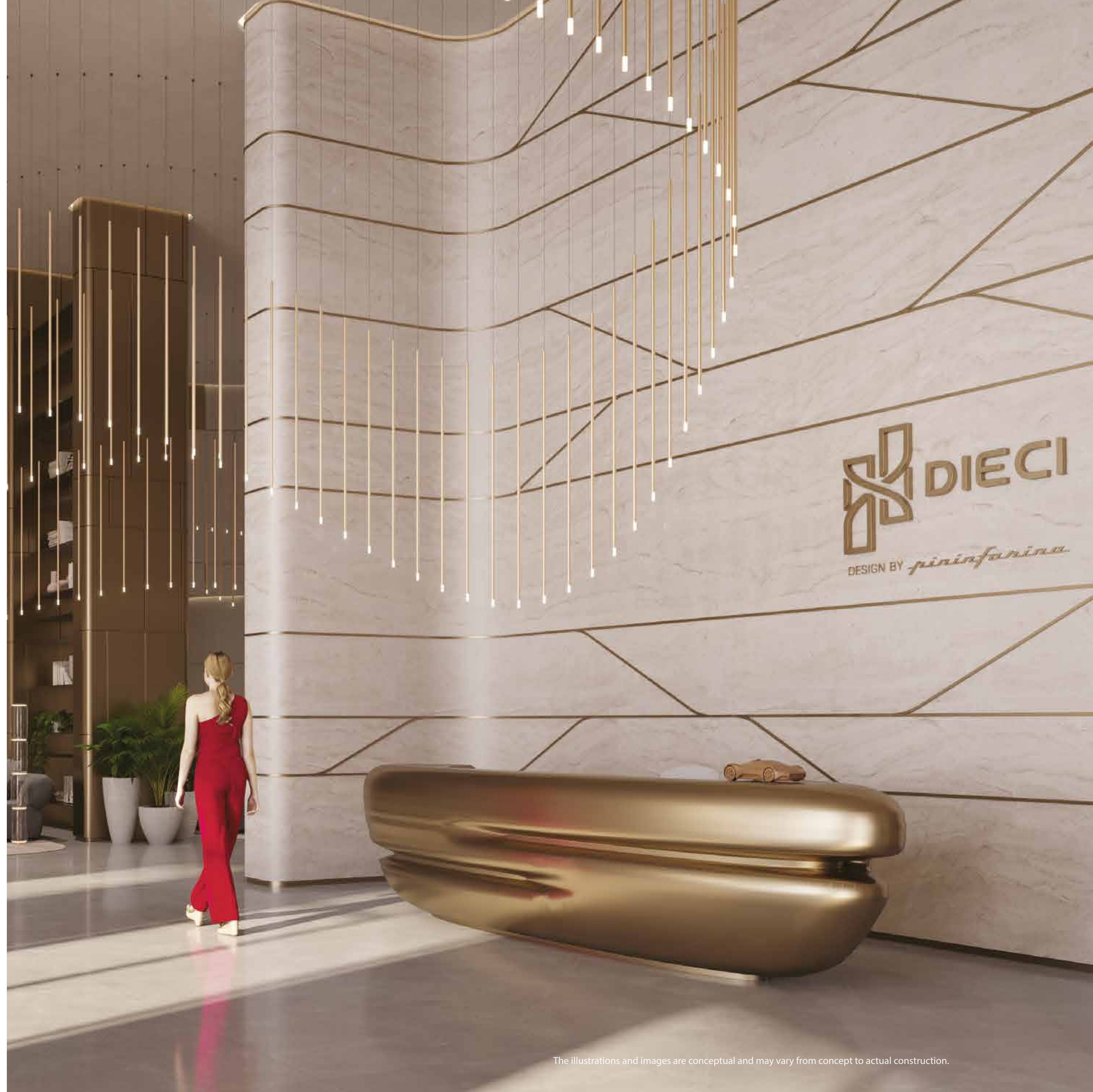



DIECI
DESIGN BY *piainfarina*

wellness center
media room

torre este >
< co-work



ULTRA-LUXURY BUILDING EXPERIENCES

PODIUM FLOOR

The podium area is a tropical gathering space that fosters real connections within the DIECI community. A stunning garden surrounded by views of Costa del Este, it invites residents to a 360-degree sensory living experience with dedicated areas for family, friends and pets. This place serves as a hub for creating unforgettable memories.

Podium

- Terrace Garden
- Outdoor Cinema
- Yoga Deck
- Lounge & Event Hall
- Chef's Signature Kitchen
- Kid's Plaza
- Arcade Room
- Pet Zone

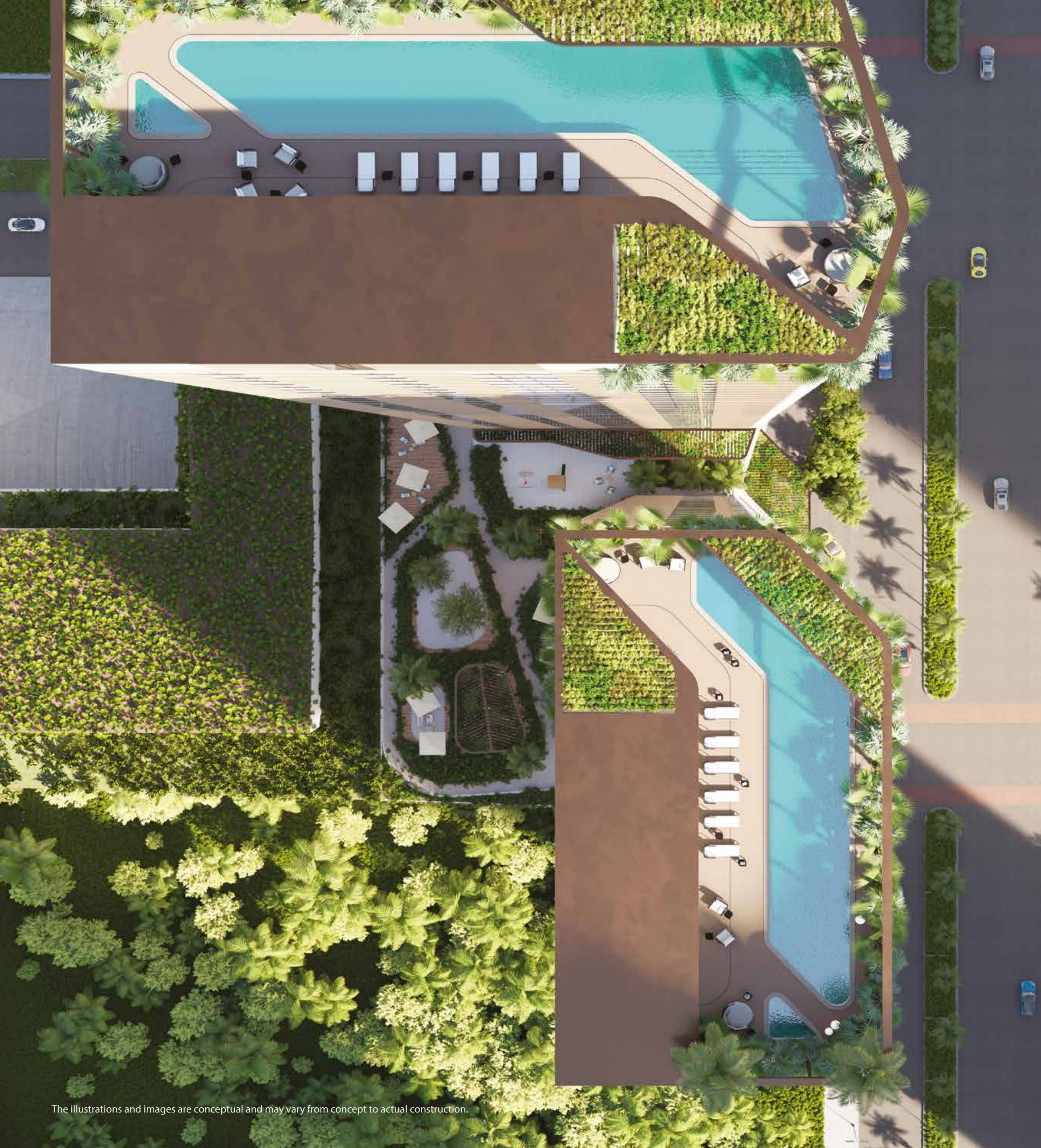

ULTRA-LUXURY BUILDING EXPERIENCES

ROOFTOP FLOOR

At the journey's end lies the beach. DIECI's rooftop design is curated to embody an effortless and sophisticated art of living. Panama's Caribbean islands inspire the look and feel of the pool area and terrace bar, which features an aromatic green wall with fresh herbs available for crafting refreshing cocktails.

- Rooftop
- Pool Club
- Terrace bar
- Solar decks
- Towel Service
- Hydro spa

DIECI Club

- A place to be surprised





The illustrations and images are conceptual and may vary from concept to actual construction. Images courtesy of Pininfarina's product design.

An inspiring legacy made to your measure





Contemporary living experience
curated by Pininfarina

Tower 1

DIECI A1/A2 Closed Area 92.4 Sq. m Open Area 21 q. m Total 113.4 Sq. m
 Closed Area 994.59 Sq. f Open Area 226.04 Sq. f Total 1,220.63 Sq. f

DIECI B1/B2 Closed Area 91.2 Sq. m Open Area 21.5 Sq. m Total 112.7 Sq. m
 Closed Area 981.67 Sq. f Open Area 231.42 Sq. f Total 1,213.09 Sq. f

DIECI E Closed Area 163 Sq. m Open Area 21.4 Sq. m Total 184.4 Sq. m
 Closed Area 1,754.52 Sq. f Open Area 230.35 Sq. f Total 1,984.87 Sq. f

Tower 2

DIECI A1/A2 Closed Area 92.4 Sq. m Open Area 21 q. m Total 113.4 Sq. m
 Closed Area 994.59 Sq. f Open Area 226.04 Sq. f Total 1,220.63 Sq. f

DIECI B1/B2 Closed Area 91.2 Sq. m Open Area 21.5 Sq. m Total 112.7 Sq. m
 Closed Area 981.67 Sq. f Open Area 231.42 Sq. f Total 1,213.09 Sq. f

DIECI F Closed Area 160.2 Sq. m Open Area 22.8 Sq. m Total 183 Sq. m
 Closed Area 1,724.38 Sq. f Open Area 245.42 Sq. f Total 1,969.80 Sq. f

Podium

DIECI A1/A2 Closed Area 92.4 Sq. m Open Area 21 q. m Total 113.4 Sq. m
 Closed Area 994.59 Sq. f Open Area 226.04 Sq. f Total 1,220.63 Sq. f

DIECI B1/B2 Closed Area 91.2 Sq. m Open Area 21.5 Sq. m Total 112.7 Sq. m
 Closed Area 981.67 Sq. f Open Area 231.42 Sq. f Total 1,213.09 Sq. f

DIECI D Closed Area 94.86 Sq. m Open Area 23 Sq. m Total 117.9 Sq. m
 Closed Area 1,020.71 Sq. m Open Area 247.57 Sq. m Total 1,268.28 Sq. m

DIECI C Closed Area 143.6 Sq. m Open Area 27.2 Sq. m Total 170.8 Sq. m
 Closed Area 1,545.70 Sq. m Open Area 292.78 Sq. m Total 1,838.49 Sq. m

The illustrations and images are conceptual and may vary from concept to actual construction.